

# QUICK START GUIDE

Wifi Digital Calendar for Family Schedules

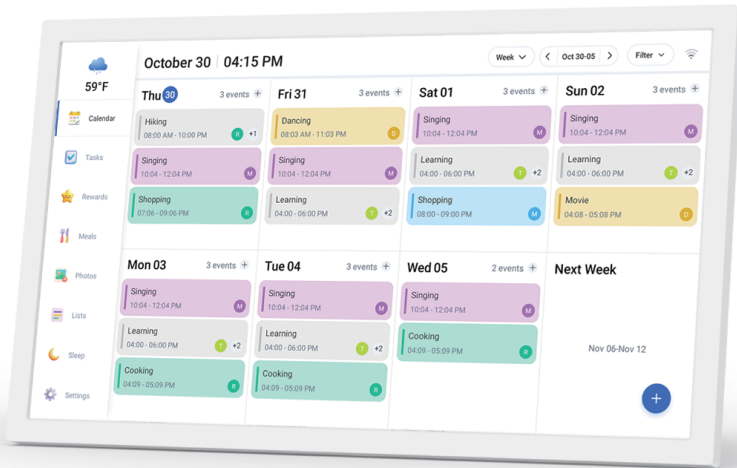

Scan the QR code to download User Manual

Support email: [support@agilespacetime.com](mailto:support@agilespacetime.com)

Make sure the following items are in the box with your Calendar.

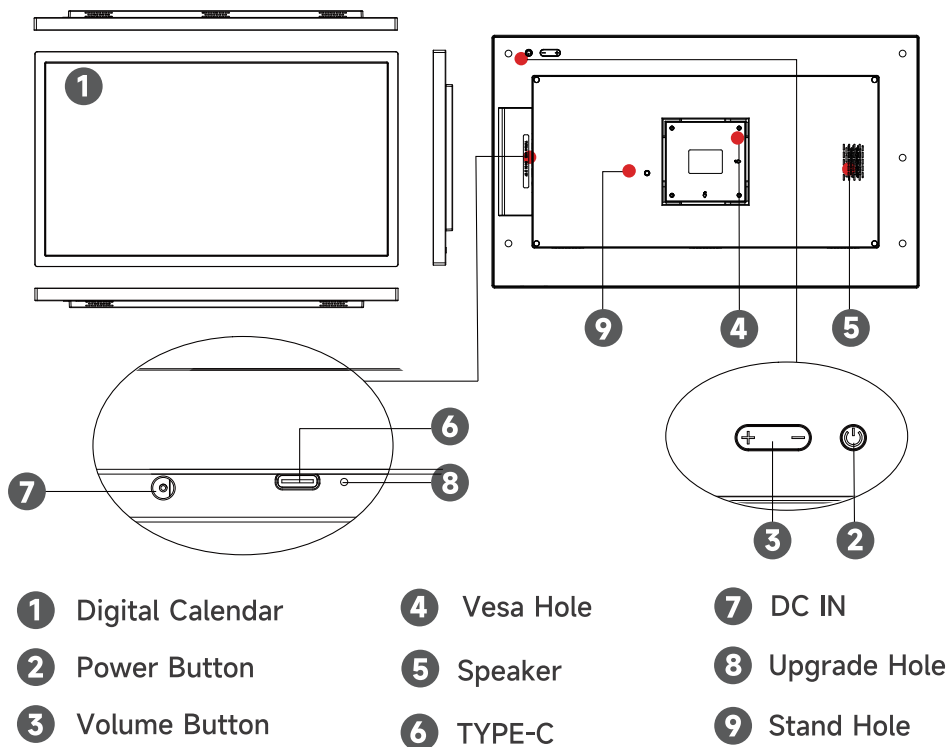
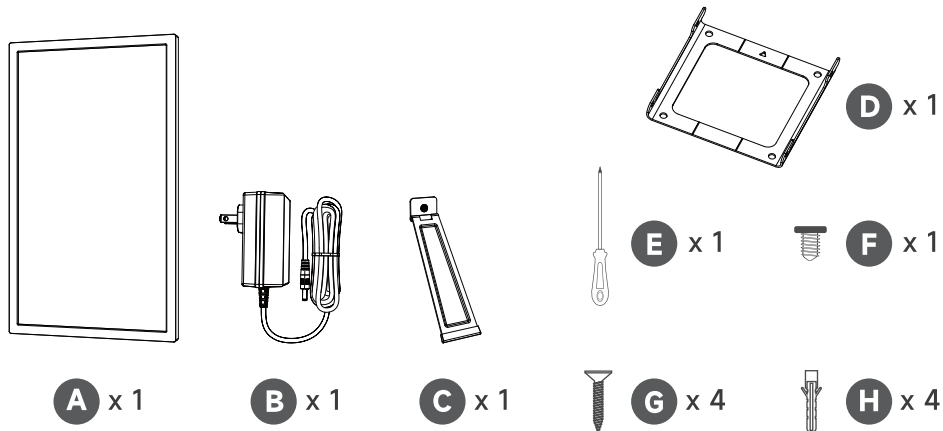

# Bracket Installation Guide

## Accessories required

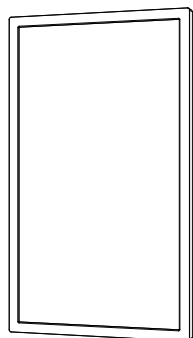

**A** x 1



**E** x 1



**F** x 1

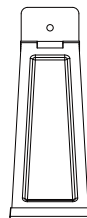

**C** x 1

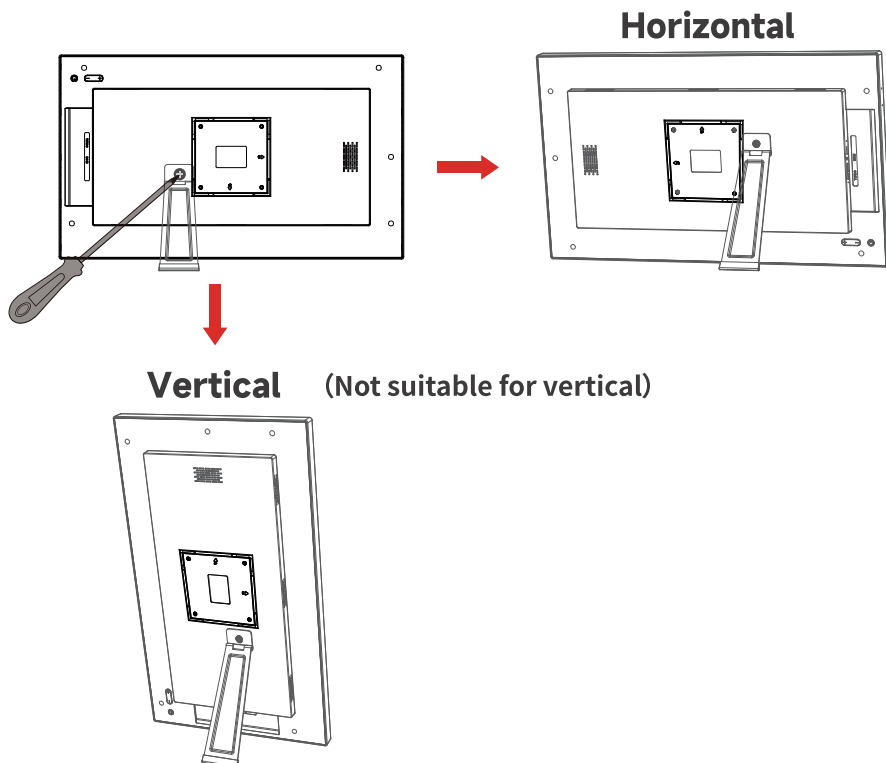

# Quick Start Guide – Wall Mount Installation

## Accessories required

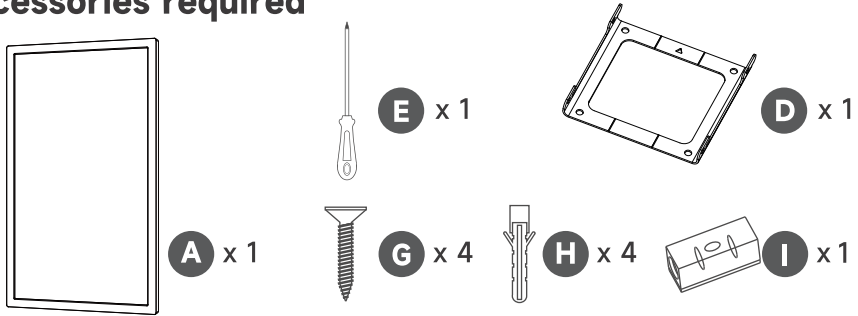

### 1. Prepare the Mounting Bracket

Take out the wall-mount bracket and ensure all screws and accessories are included.

### 2. Mark the Installation Position

Place the level accessory on the bracket and adjust it until the bracket is level and positioned at the desired height and location.

Use a pencil to mark the screw hole positions on the wall through the bracket.



### 3. Drill the Holes and Secure the Bracket

Use an electric drill to drill four holes at the marked positions.

The hole diameter should be slightly smaller than the outer diameter of the plastic wall anchors (**H**), and the depth should be sufficient for the anchors to be fully inserted.

Insert the plastic wall anchors and fasten the bracket securely with screws.

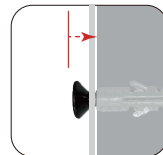
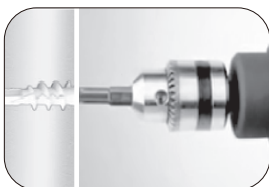

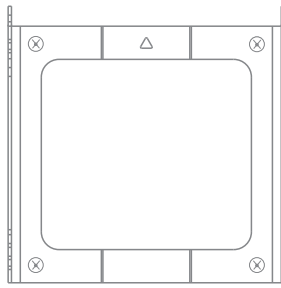

#### 4. Attach the Device to the Bracket

Align the mounting slots on the back of the device with the hooks or grooves on the bracket.

#### 5. Hang and Lock the Device

Gently slide the device downward until it locks into place. Ensure the device is stable and fully secured on the bracket.

#### 6. Final Check

Gently pull the device forward to confirm it is firmly installed and does not wobble.

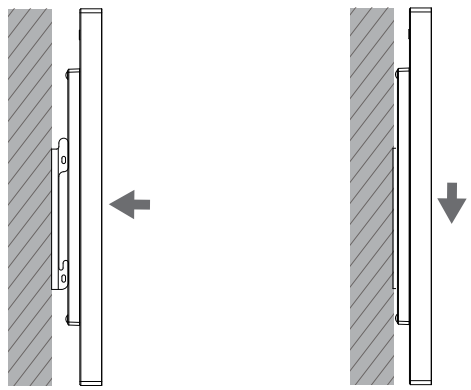

\* The Calendar frame, supports both horizontal and vertical wall mounting.

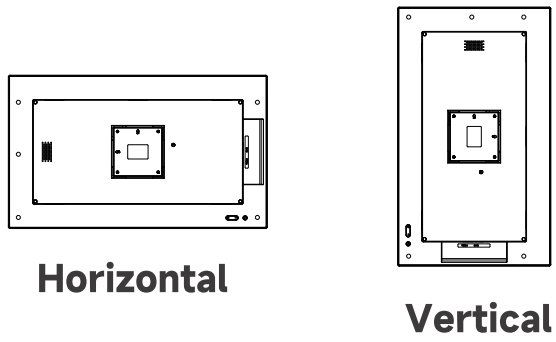

## **Warranty**

The product is covered by a 12-month limited warranty from the date of purchase. Please note this warranty becomes void if:

1. The factory-supplied serial number has been removed or altered
2. The "warranty void" sticker is tampered with or damaged

### **This warranty does not cover:**

1. Cosmetic damage or damage resulting from external factors.
2. Damage caused by improper operation, maintenance, or connection to incompatible equipment
3. Unauthorized modifications or repairs performed by third parties.

## **Contact Us**

We're here to help! Contact us anytime with your questions or needs - our support team is always ready to assist.

Email: [support@agilespacetime.com](mailto:support@agilespacetime.com)